

# TRAILER KIT ASSEMBLY GUIDE

ALUMINUM TRAILER KIT MODELS (4842, 4872, 4884, 6096)

**Read the owner's manual completely before you assemble the trailer.**



# BUILD IT & SAVE!



# ALUMINUM TRAILERS

## Kit Assembly Guide

©2005 V.L. Webb All Rights Reserved

# Aluminum Trailer Kit Assembly Overview

**VERY IMPORTANT:** ALWAYS REFER TO YOUR OWNER'S MANUAL FOR PROPER OPERATING AND SAFETY INFORMATION REGARDING YOUR TRAILER & PARTS LIST.



## **Step 1: Remove All Parts**

Remove all the parts from inside the trailer box and set them aside as shown above.

## **Step 2: Prep The Trailer Frame for Assembly**

Flip the trailer frame upside down and set corners on blocks as shown below. The photo below is shown with the springs, axle, fenders, wheels, tongue, side markers and rear tail lights attached.



## **Step 3: Gather Tools Needed**

Gather the tools required to assemble the trailer as outlined below:

- 7, 13, 14, 17, 19, 22mm sockets w/ ratchet, ratchet extension & open end wrenches.
- Small phillips screw driver, large flat head screw driver, rubber mallet, adjustable pliers
- 8mm allen wrench for instillation of the sleigh chock to trailer.

# HARDWARE KIT



**NOT PICTURED:** 1) Safety chains mounting bolt for tongue uses 17mm ratchet & wrench, 2) the side markers have a Phillips screw driver head bolt uses 7mm ratchet or wrench for lock nut, 3) Tail light mounts use a 13mm ratchet or wrench for lock nuts.

## Tongue Assembly Checklist



**Attach Pivot Bolt**

**Insert L Pin**

**STEP 4:** Place the trailer tongue into the tongue mount with the tongue stand facing up. Make sure the Wire harness is out on both ends. Use **19mm ratchet & wrench** to attach and secure the tongue using the pivot bolt to the back of the tongue mount. Slide the L-pin that is attached to the front of the frame through the tongue mount and tongue. Make sure to secure the L pin with the attached cotter pin.



**(1) Safety Chain Bolt**

**(2) Coupler Bolts**

**STEP 5:** Use **22mm ratchet & wrench** to attach and securely tighten the coupler as shown to the front of the trailer tongue. Use **17mm ratchet & wrench** to attach and securely tighten the safety chains on each side of the tongue as shown in the above picture.



**STEP 6:** Connect the 12v tongue wire plug into the 12v trailer frame wire plug.

**Please check and re-check the tightness of the Nuts & Bolts of the pivot bolt, coupler bolts and Safety Chains bolt on the Tongue to insure that they are Properly secured.**

## Axle, Fender & Wheel Install Checklist

**STEP 7:** Lay the slipper springs in the spring track with the slipper portion of the spring installed under the pre-mounted bolt as shown in the below left photo. Make sure the spring eye is facing towards the front of trailer frame.



Use **22mm ratchet & wrench** to attach and securely tighten the spring eye bolt as shown in the above right photo.

**STEP 8:** The fenders are universal and can be mounted on either side - Use the **14mm ratchet & 14mm open end wrench** to attach and securely tighten the 4 bolts, washers and lock nuts from the blister pack to the trailer frame for each fender.



**STEP 9:** Attach the axle to the springs - use the U Bolts as shown in the picture. The springs have a male nub which will match up to the female nub hole on the axle. Make sure the male nub is in the female nub hole before mounting the U Bolts. Use the 17mm ratchet to attach and securely tighten the U Bolts to the axle and springs. Refer to photo on right above to see what the finished axle assembly should look like once mounted properly.



**STEP 10:** Tire/Wheel Assembly – Remove the cotter pin with pliers and then remove the spindle nut from the axle. Slide the tire & wheel assembly onto the axle. Make sure the valve stems facing outward on the wheel. Gently tighten the spindle nut and replace cotter pin as shown in the above left photo and then re-install dust cover. Then check the wheel lug nuts (19mm) are properly secured onto the hubs with 65-70 ft-lb of torque as shown in the above right photo.

## Step 11: Light Assembly Checklist

Identify which light is the right side and left side by looking at the bottom of the tail lights as shown below. The left light (driver's side) has a clear lens in the bottom for the illumination of the state license plate which also includes a license plate bracket.

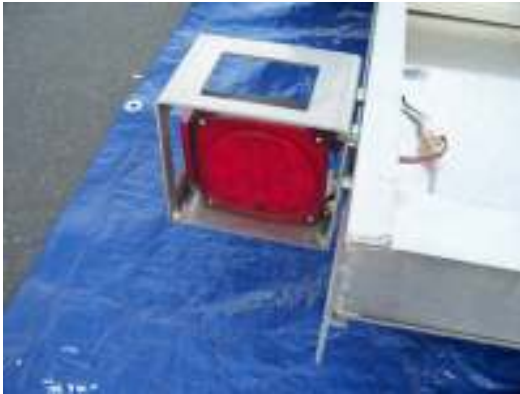

**Rear LED Light Assembly** – Use a **13mm ratchet** or **open end wrench** to attach rear light protectors to the frame as shown below. The tail lights are plug & play, locate the wire harness for the rear lights on the frame and plug in the connector from the lights into the wire harness on the trailer frame as shown below.



**LED Side Markers** - Use a **small Phillips screw driver** and a **7mm ratchet** or **open end wrench** to attach side markers to the frame as shown below. Please review the pictures below to make sure the side markers are mounted as shown. The side markers are plug & play. Locate the wire harness for the side markers on the frame and plug in the connectors from the lights into the harness.



## TRAILER COMPLETION & FINAL CHECK



**STEP 12: USE EXTREME CAUTION:** Using at least (2) strong bodied people, safely flip the trailer over by standing the trailer on end (its rear frame) and carefully flip it over to support itself on the wheels and the tongue stand. **Do not attempt this if you do not have;** 1.) Adequate clearance above and from side to side and 2.) Enough man power that can SAFELY handle the weight of the trailer when flipping it over.



VIN & Tire  
Placards

**STEP 13:** Apply VIN Tag & Tire Placard. Mount the side markers (by law the labels must be mounted on the driver's side.) The best placement for the labels is on the top of the tongue as shown or the actual trailer frame.

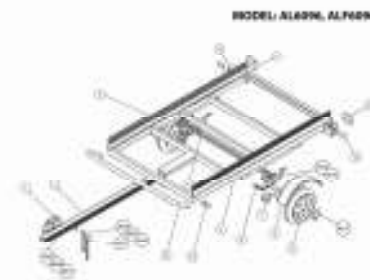
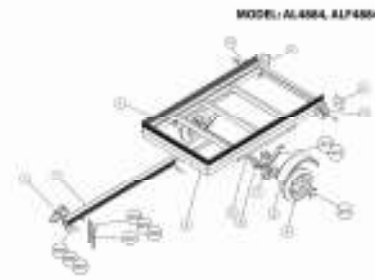
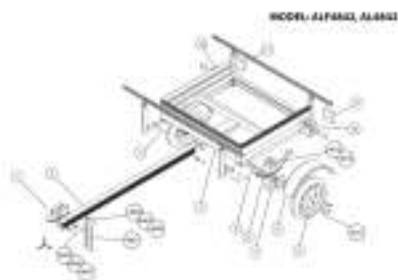

**STEP 14: VERY IMPORTANT:** With your OWNER'S MANUAL in hand, completely go back over your parts list and make sure that YOU have properly installed your parts and any additional parts or accessories not included in the basic trailer assembly guide. Make sure these are installed correctly.

**SEE ATTACHMENTS TO ASSEMBLY GUIDE:** Sleigh chock for AL6096 and Anchor Track for AL4842 have additional instructions (ANY QUESTIONS, visit [www.utilitysport.com](http://www.utilitysport.com))

# Enjoy Your Trailer

**REMEMBER;** Always refer to your owner's manual for all the safety, maintenance, tire inflation, load capacity, and operator instructions.

# FLOOR DECKING INSTALLATION

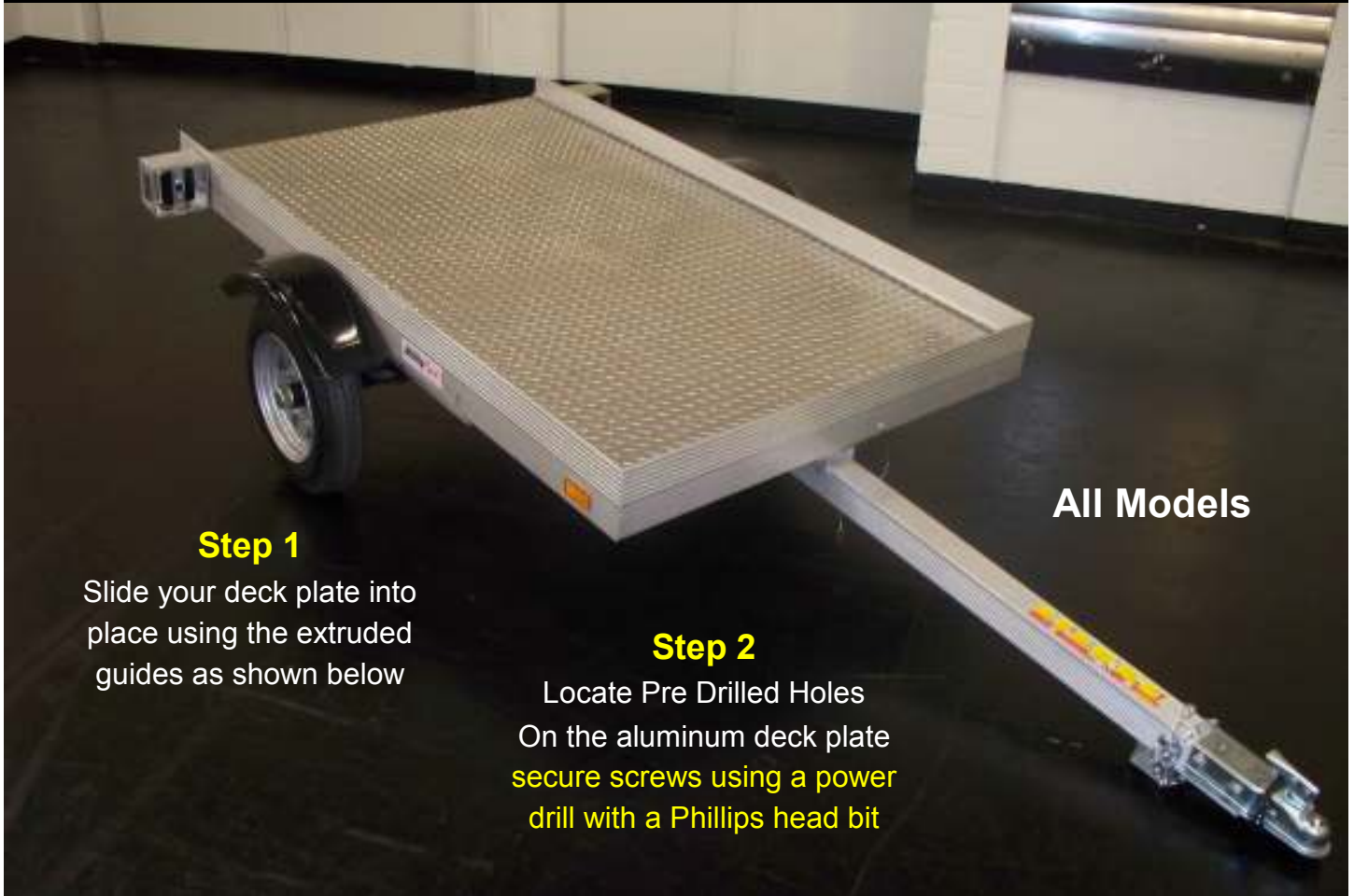

All Models

## Step 1

Slide your deck plate into place using the extruded guides as shown below

## Step 2

Locate Pre Drilled Holes  
On the aluminum deck plate  
secure screws using a power  
drill with a Phillips head bit

**NOTE:** Always make sure you decking material is attached securely to the frame of the trailer.

**Step 1)** For ALF models, slide your deck plate using the extruded guides located on the right and left side of the trailer as shown in Step 1 below, the deck plate has a sticker which indicates the FRONT end of the plate to slide in first.

**Step 2)** A bag of 1/4" by 1" steel self tapping screws are provided with the ALF series models. For the AL models 1/2" plywood or 2" lumber can be used for decking. Make sure the decking material is secured with steel self tapping screws that penetrate the wood and aluminum cross beams by at least 1/2" when installed. Bolts are also a viable option when securing the deck to the trailer frame. Recommended diameter for screws or bolts is 1/4" or larger.



Step 1

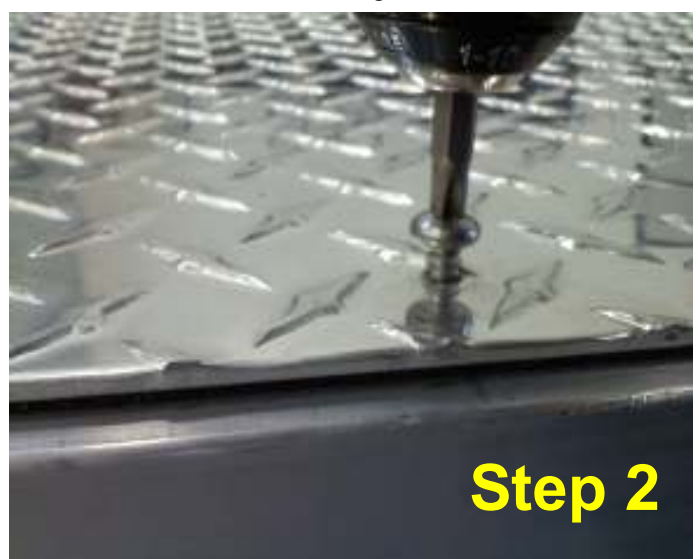

Step 2

# SLEIGH CHOCK INSTALLATION

**MODEL: AL6096, ALF6096**

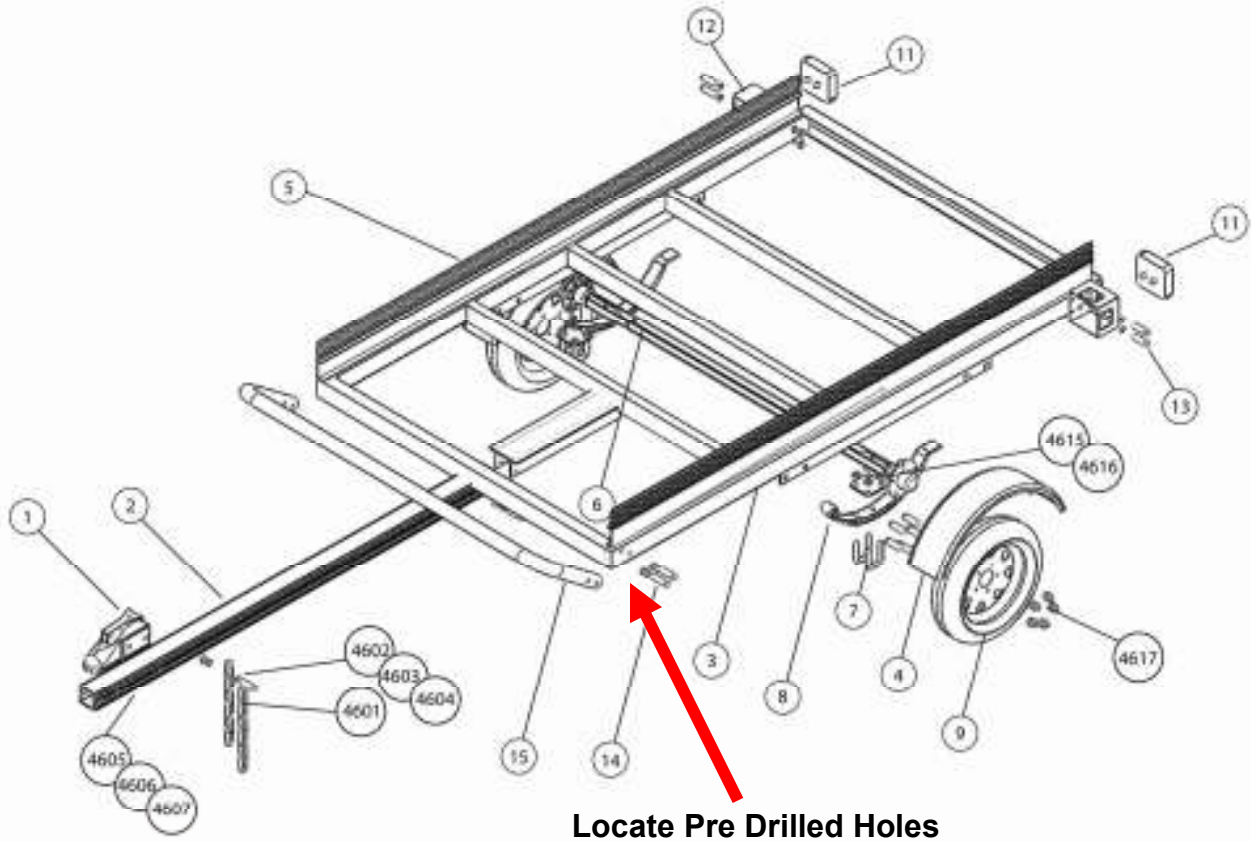

**Locate Pre Drilled Holes**

Attach the SLEIGH CHOCK as shown in the diagram above. **Use the 8mm allen wrench and a 17mm ratchet or open ended wrench** to attach and securely tighten the sleigh chock to the front of the trailer frame. Note that the frame has pre drilled holes for the sleigh chock. Refer to picture below to see what the finished "Sleigh Chock" should look like once mounted properly to the trailer.

**Use 8mm allen wrench**



# ANCHOR TRACK INSTALLATION

AL4842 / ALF4842

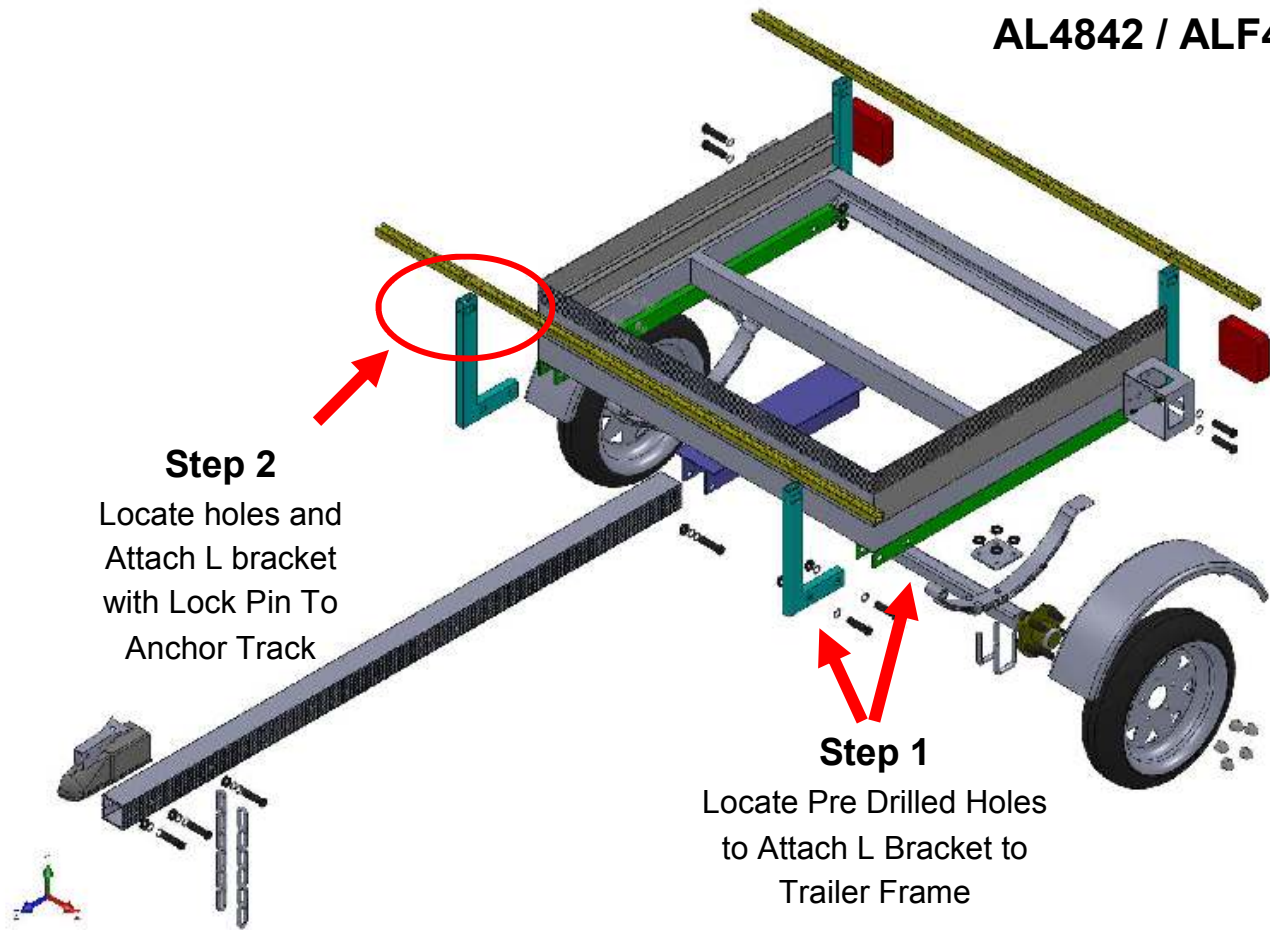

## Step 2

Locate holes and  
Attach L bracket  
with Lock Pin To  
Anchor Track

## Step 1

Locate Pre Drilled Holes  
to Attach L Bracket to  
Trailer Frame

**NOTE:** Before attaching L brackets, please make sure your trailer bed (flooring) is installed if applicable.

Step 1) Attach the L brackets as shown in the diagram above. **Use 17mm ratchet or open ended wrench** to attach and securely tighten the L brackets to the 4 corners of the trailer frame. Note that the frame has pre drilled holes for the L brackets.

**Step 2)** Attach the anchor track to the top of the L bracket using the (4) lock pins included and pre drilled holes. Please refer to the picture below to see what the finished “L Bracket” and “Anchor Track” will look like once mounted properly to the trailer.

